

Amphenol
ORIGINAL
PDF Format
R&D

REV	ECN	DESCRIPTION	DATE	MODIFIED
1		PER RELEASE	Nov-10-2023	
2	R7957N	UPDATED LABEL TEXT ON METERING WIRES&NOTES	Mar-29-2024	
3	C7806N	UPDATED NOTES	Apr-28-2024	

Total Length	Tolerance
0~1000mm	±50
1001~5000mm	±100
>5000mm	±200

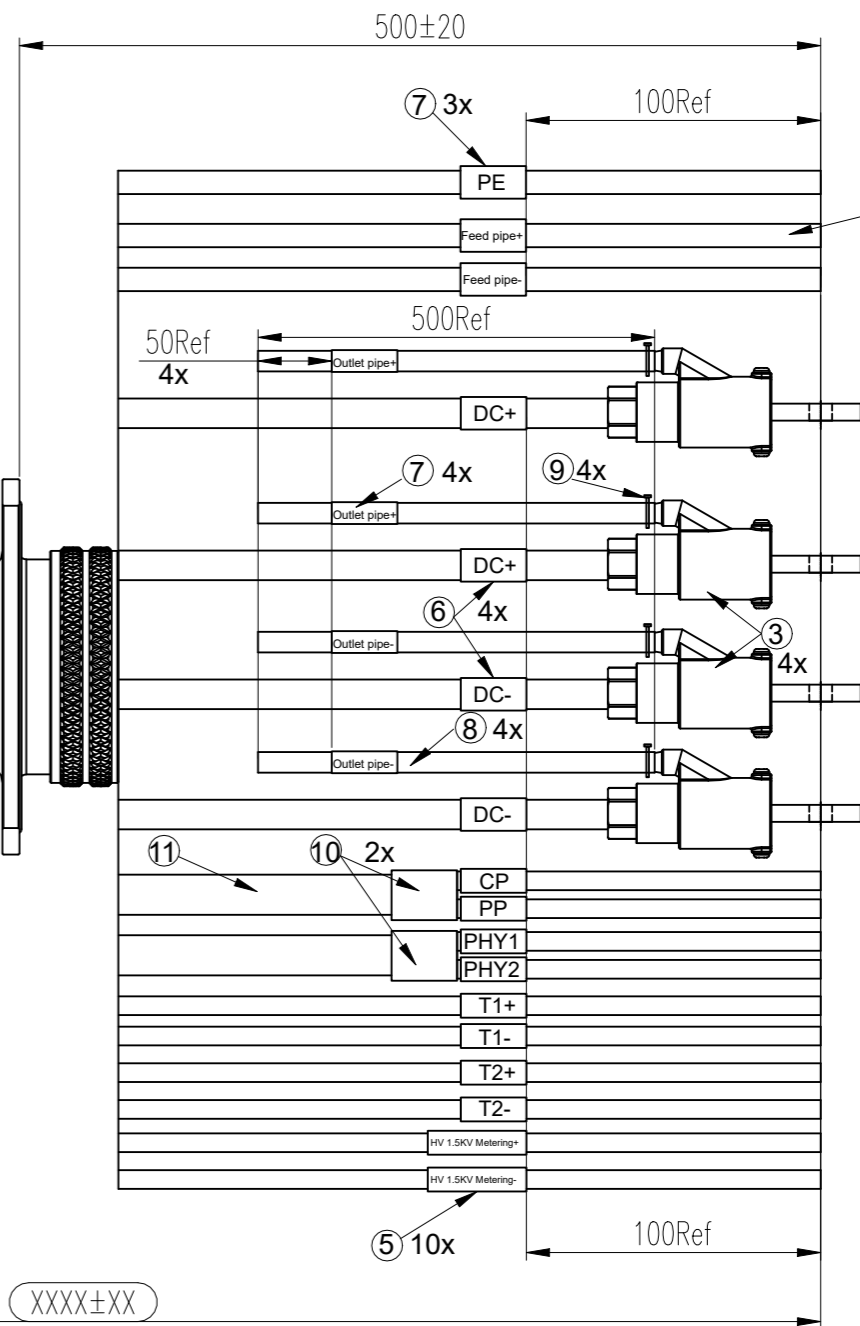
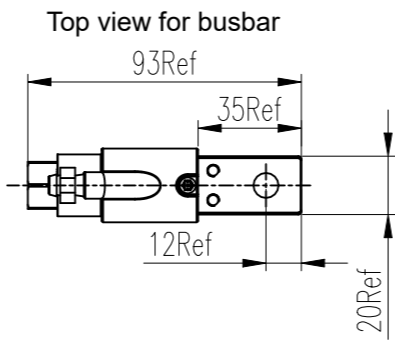
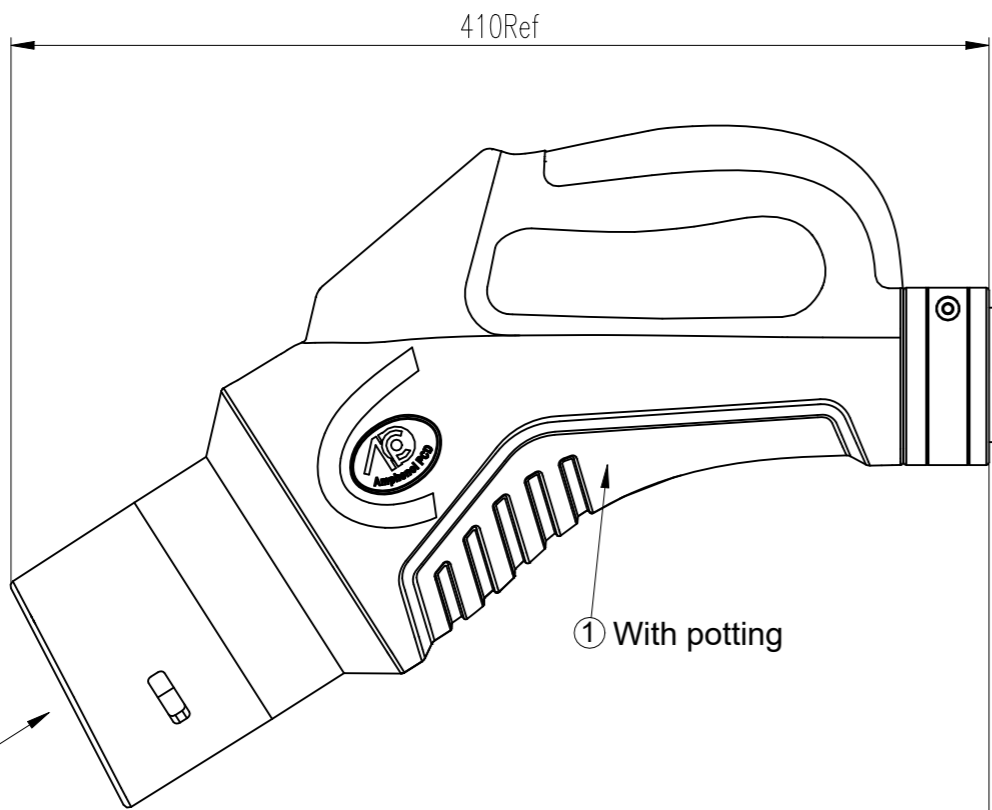
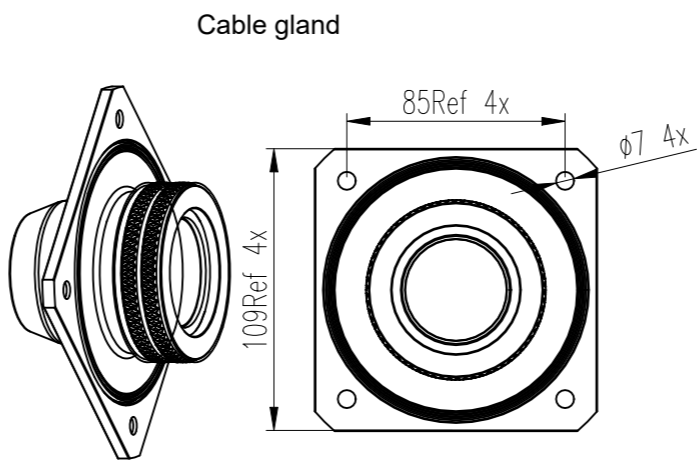

Tube size:
ID8 OD10

Front view

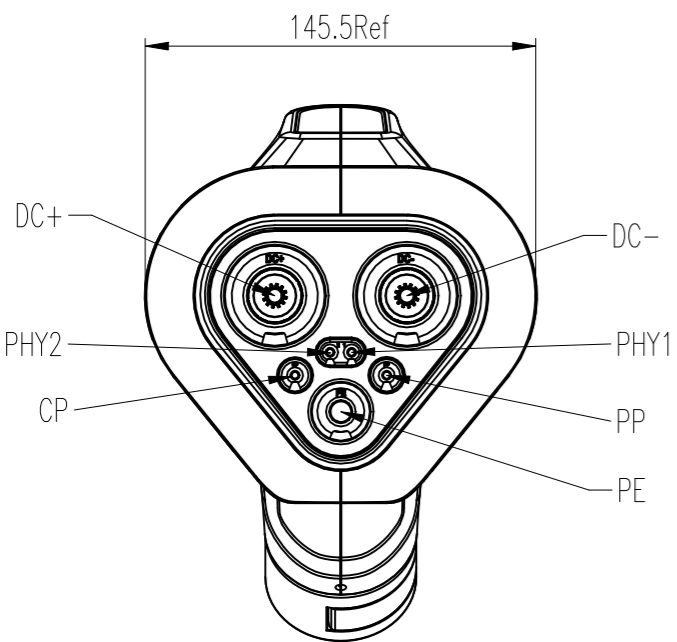

Front view

DIMENSIONS	TOLERANCES	PROJECTION	TITLE		
ANSI Y14.5M UNITS: MM CAD FILE	.X ± 0.50 .XX ± 0.05 ANGLES ± 2°		MCS 1500A VEHICLE CONNECTOR CABLE ASSEMBLY		
ORIGINAL	THIS DOCUMENT CONTAINS PROPRIETARY INFORMATION WHICH IS THE CONFIDENTIAL PROPERTY OF Amphenol PCD Shenzhen Co. Ltd Amphenol PCD Shenzhen Co. Ltd RESERVES THE RIGHT TO CLARIFY THIS DRAWING		Amphenol PCD Shenzhen		REV 3
			ENGR	Nov-10-2023	SIZE A3
			CHKD	SCALE 1:1	SHEET 1 OF 2
			APPD		

C-HVCO4M1001LXXXX

C-HVCO4M1001LXXXX

Marking

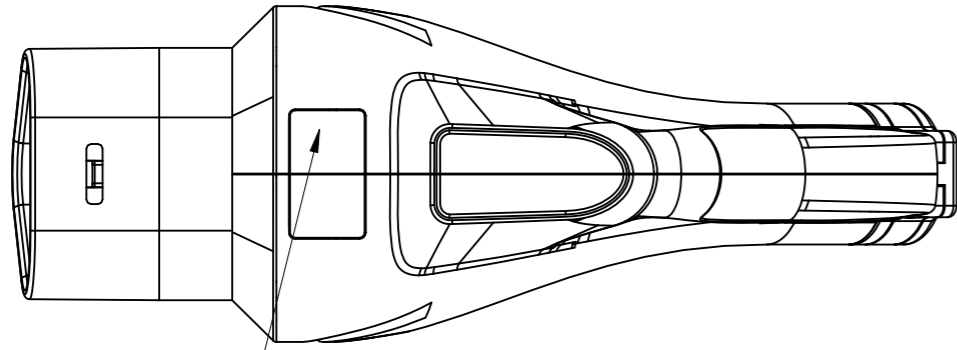

CN:Made in China
MX:Made in Mexico
US:Made in US



QR code,
Content including:Part number
#Work order number XXXXXX
Serial number XXXX ex:0001
(ex:HVCO4M1001L5000#123456#0001)

T/N:XXXXXXXX YYWW
Work order number + Batch number+Year+Week
Font:Arial 3mm Ref

Mode of Connection

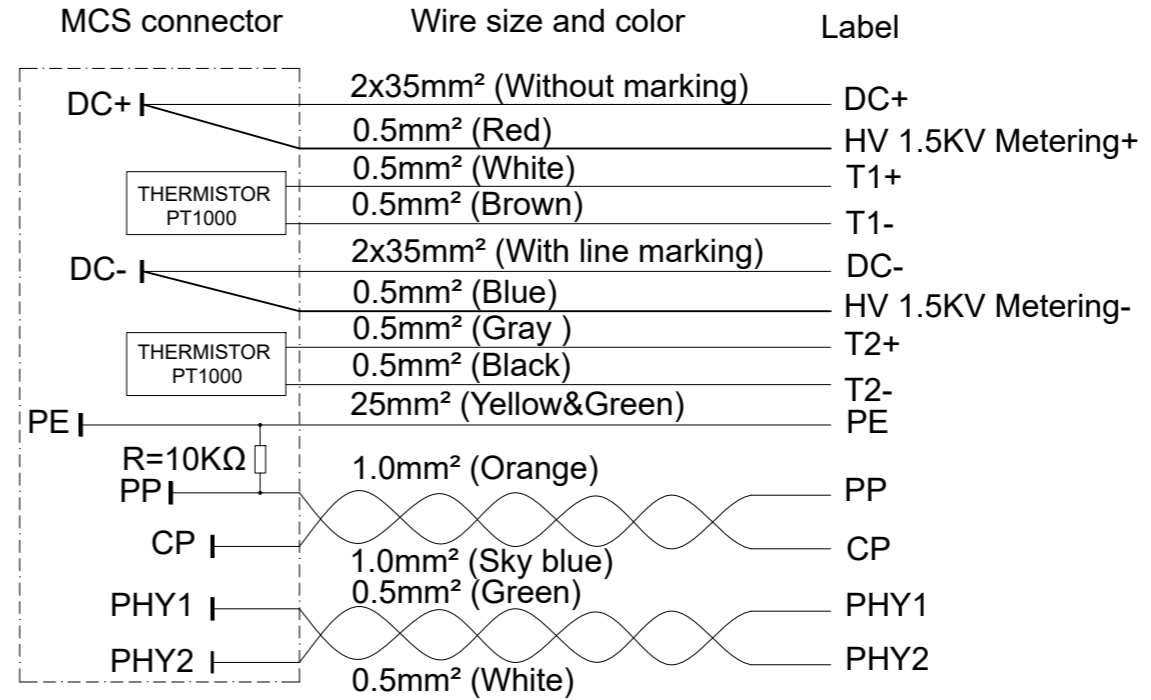

*Notes:

- Cable assembly data:
 - Rated Voltage:1500V DC(DC+&DC-&Metering wires),30V DC(CP&PP&PHY1&PHY2);
 - Rated Current: 1500A Max(DC+&DC-) @ the max permissible temperature of contact is 100°C(Max T-rise is 50°C)
the max permissible temperature of cable is 85°C
 - 2A Max(PHY1&PHY2), 10A Max(CP&PP);
- Insulation Resistance:100MΩ Min(1500V DC FOR DC+&DC-,500V DC for others)
- Withstand Voltage : 4000V/AC r.m.s(DC+&DC-); Others 500V/AC r.m.s
- IP-Class: IP67(enclosure);IP44(Plugged in)
- RoHS Compliance
- Ambient Temperature: -40°C ~ +50°C(+55°C max, Current reduction required,when the working temperature is beyond 80°C)
Storage temperature:-40°C ~ +80°C
- IEC Plug reference:C-HVCO4M1001
- Cable Minimum Bending Radius:≥10 OD DC+ and DC- Minimum Bending Radius:≥200mm
- Durability: ≥ 20000 cycles
- Working Pressure:0~7bar;
Cooling medium: Dielectric coolant
- Weight of cable: app 2.3 kg/m Weight of charging connector: app 3.5 kg/EA
- T-rise depends on flow rate and chiller, Detailed technical data please refer to MCS Technical Data Sheet.
- For HV 1.5KV Metering wires:Please protect with insulated material
at the tail if don't use both wires

⑪	C2100054031	SINGLE-WALL H.S.T: Ø8.0 BLACK	0.4	m
⑩	C210006440	DOUBLE-WALL H.S.T: Ø8.0 BLACK	0.1	m
⑨	P01BN01331	STEPLESS EAR CLAMP/SUS304	4	EA
⑧	P01BN01497	TUBING PIPE,OD=8,ID=6	2.0	m
⑦	C210006511	SINGLE-WALL H.S.T: Ø12.7 WHITE	0.21	m
⑥	C210006512	SINGLE-WALL H.S.T: Ø19 WHITE	0.12	m
⑤	P05B000029	SINGLE-WALL H.S.T: Ø3.2 WHITE	0.27	m
④	P02B000572	CABLE GLAND	1	EA
③	P02B00053201	TERMINAL ASSEMBLY OF DC WIRE,M8	4	EA
②	P01BC00512	4x35mm ² +1x25mm ² +8x0.5mm ² +2x1.0mm ² Black OD42±1	AR	m
①	HVCO4M1001	MCS 1500A COOLING VEHICLE CONNECTOR	1	EA
ITEM	P/N	DESCRIPTION	QTY	UNIT

SIZE	DWG NO.	REV
A3	C-HVCO4M1001LXXXX	3
SCALE	NA	SHEET 2 OF 2