

IDENTIFICATION MARK  
KEY A = WHITE  
KEY B = YELLOW  
KEY C = RED

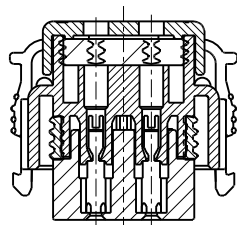

SECTION A-A

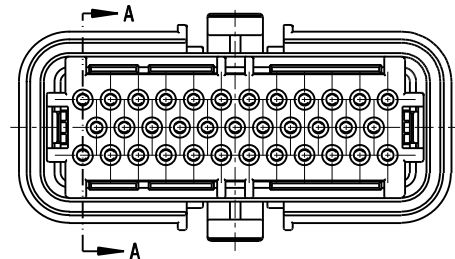
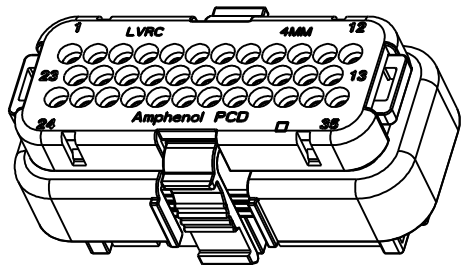
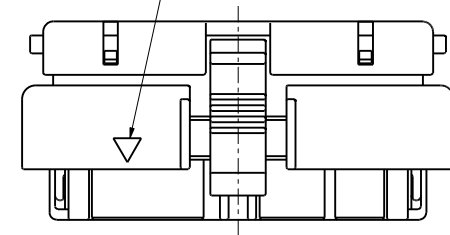
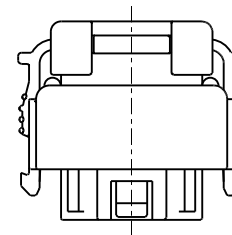
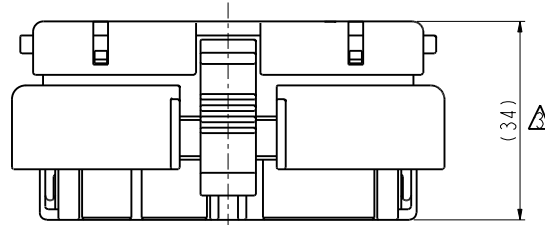

安费诺精密连接器(深圳)有限公司  
Amphenol PCD Shenzhen  
受控文件  
2019年10月10日

✦: IS CRITICAL CHARACTERISTIC SYMBOL,

⊙: IS IMPORTANT CHARACTERISTIC SYMBOL.

TECHINCAL DATA		SPECIAL CHARACTERISTICS SYMBOL
VOLTAGE RATING	250VAC / 300VDC	✦
CURRENT RATING	5A(22~18AWG)	✦
WIRE RANGE	22-18AWG WIRE INSULATION OD: 1.35-2.5MM	NA
WATERPRROF (MATED CONDITION)	IP 67	✦
OPERATION TEMP.	-40-125°	NA
MAX MATING CYCLES	50 TIMES	⊙

NOTES:

- ✦ 1. MATERIAL: HOUSING PA66 UL94 V-0, SEAL SILICONE.
- 2. MATE CONTACT AND SEAL SEE BELOW TABLE, CONTACT AND SEAL SHOULD BE ORDERED SEPARATELY. MATE CONNECTOR P/N: LVRCKM35SCRXS1.
- ⚠ THE GRAY HOUSING CANNOT BE INSERTED INTO SHELL DEEPER BEFORE INSTALL CONTACTS.
- ✦ 4. ROHS COMPLIANCE.

USED WITH CONTACT AND SEAL TYPE	
CONTACT P/N	SEAL P/N
C310023101	C220011207

DIMENSIONS	TOLERANCES	PROJECTION	TITLE		
ANSI Y14.5M UNITS: MM Pro/E FILE	.X ±0.5 .XX ±0.05 ANGLES ±2.0°		LVRC SERIES PLUG		
ORIGINAL	THIS DOCUMENT CONTAINS PROPRIETARY INFORMATION WHICH IS THE CONFIDENTIAL PROPERTY OF AMPHENOL PCD SHENZHEN		ENGR	CHKD	APPD
			SIZE A3	DWG NO. C-LVRCKF35PCXS1	REV 1
			CODE: 58982	SCALE: 13:10	SHEET 1 OF 2

C-LVRCKF35PCXS1

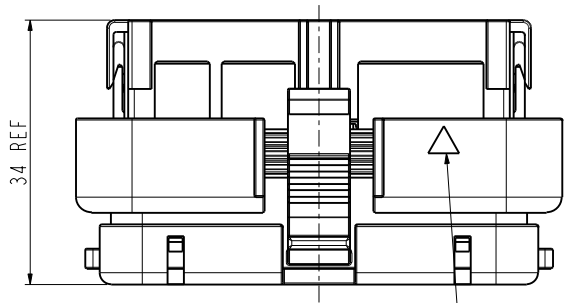
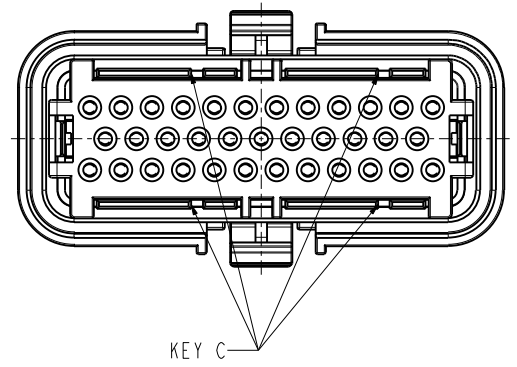
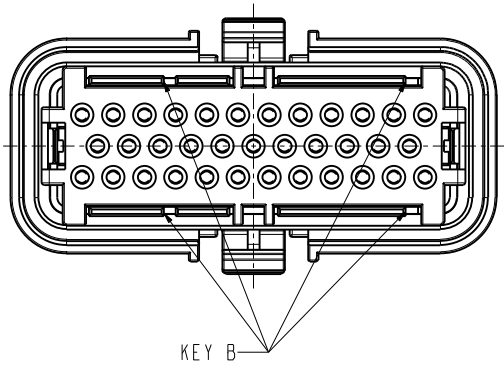
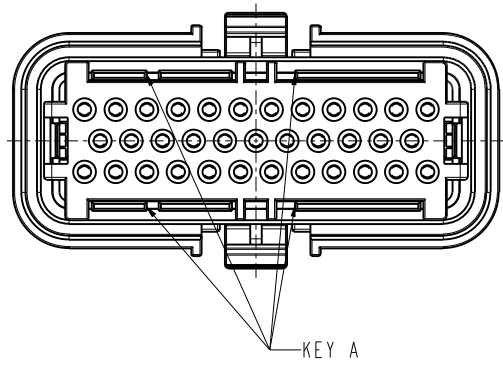

IDENTIFICATION MARK  
WHITE

LVRCKF35PCAS1

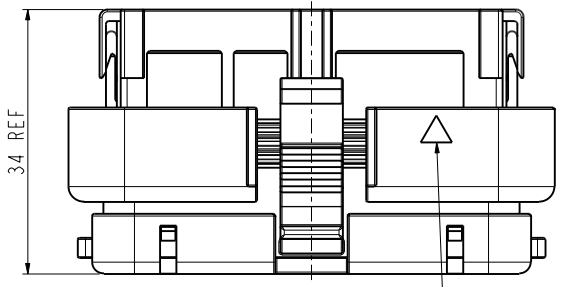

IDENTIFICATION MARK  
YELLOW

LVRCKF35PCBS1

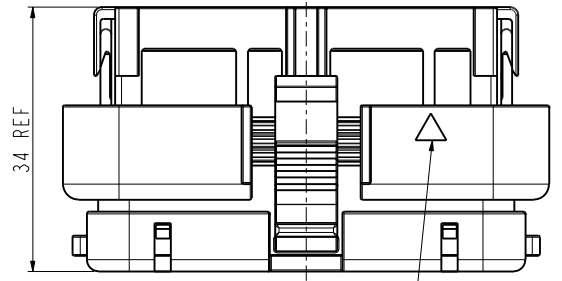

IDENTIFICATION MARK  
RED

LVRCKF35PCCS1

C-LVRCKF35PCXS1

C-LVRCKF35PCXS1

安费诺精密连接器(深圳)有限公司  
Amphenol PCD Shenzhen  
受控文件  
2019年10月10日

SIZE	DWG NO.	REV
A3	C-LVRCKF35PCXS1	1
CODE: 58982	SCALE: 3:2	SHEET 2 OF 2